

FIRST FLOOR PLAN
SCALE : 1:100

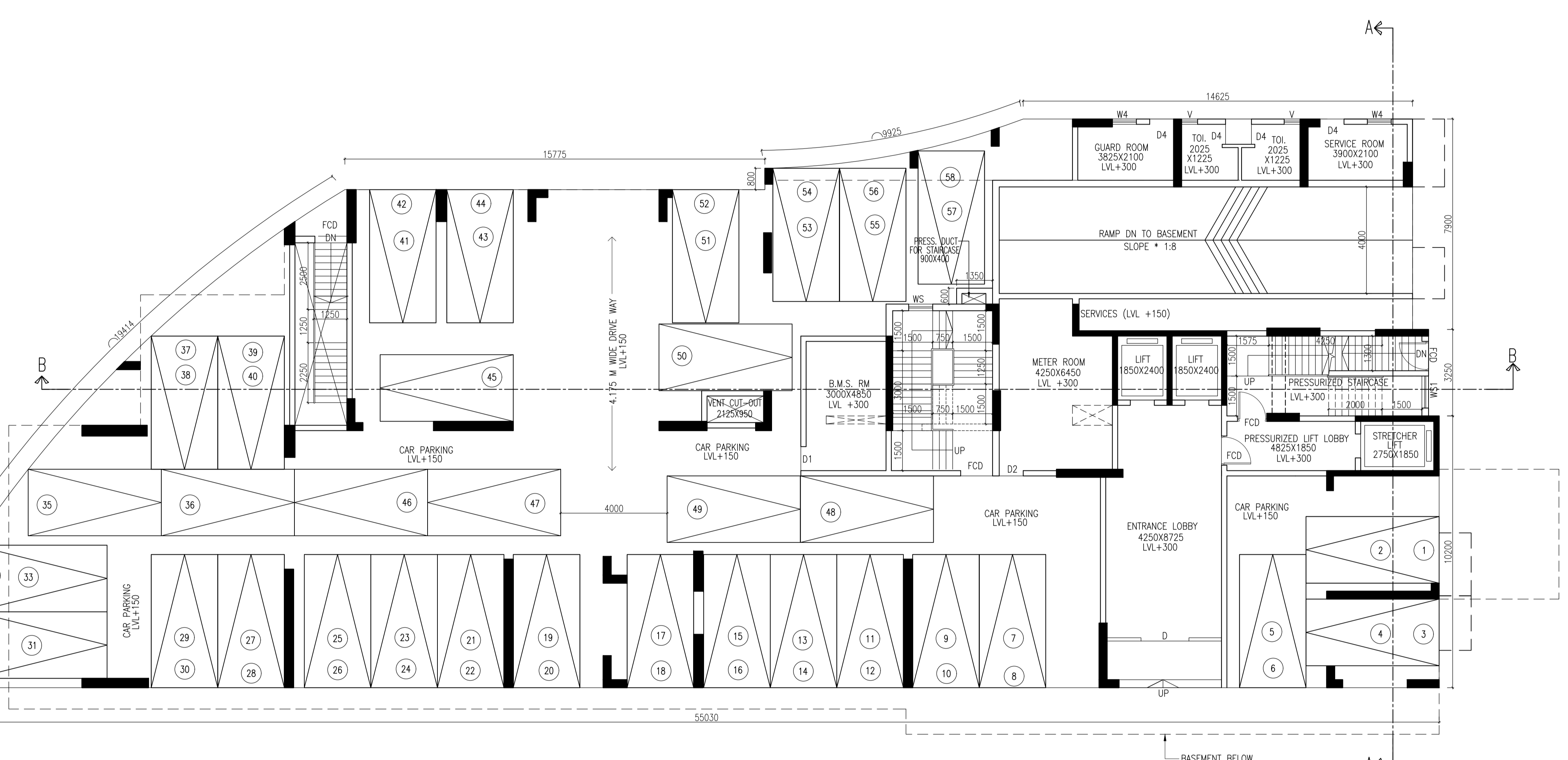

GROUND FLOOR PLAN
SCALE : 1:100

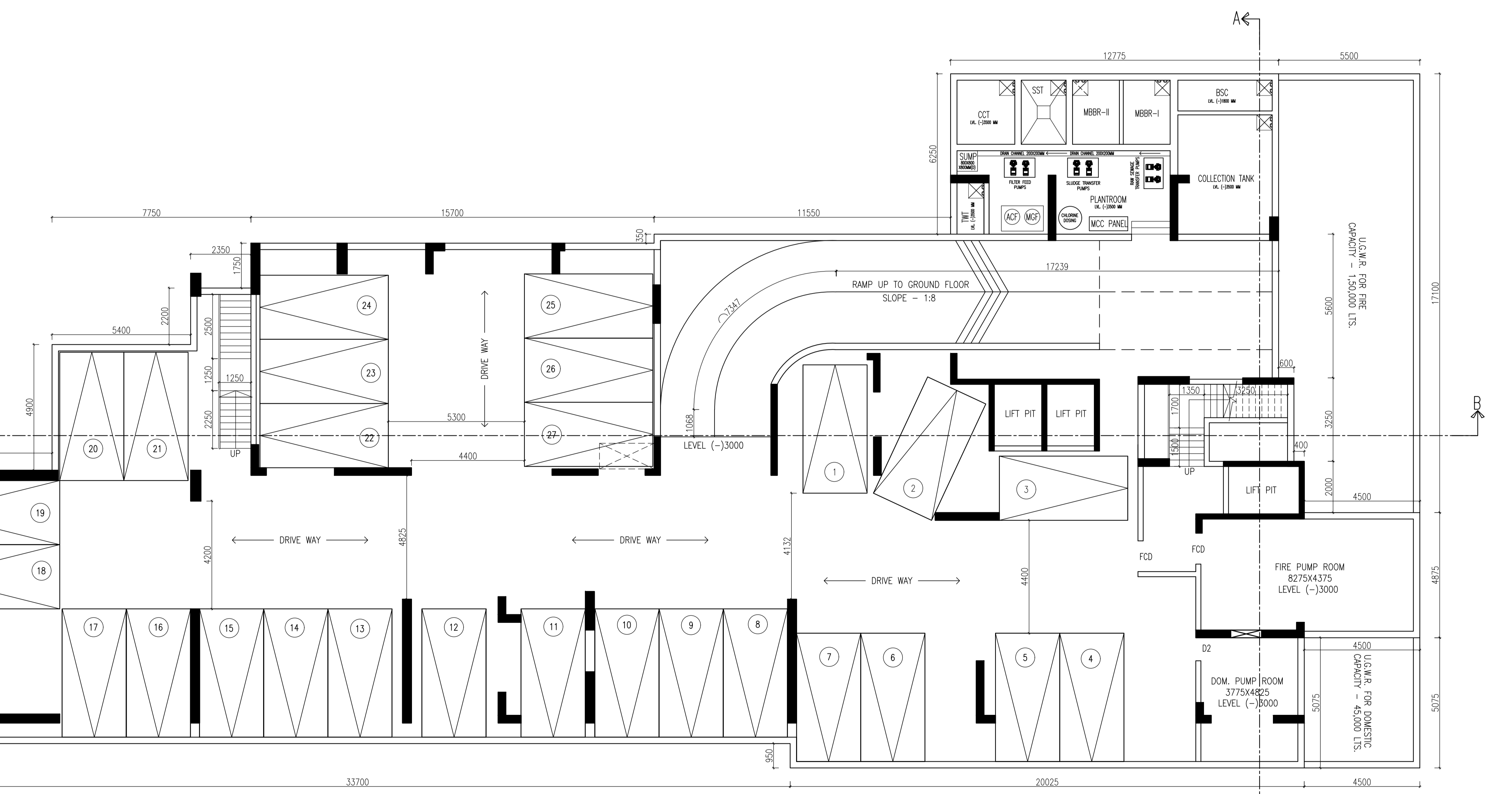

BASEMENT FLOOR PLAN
SCALE : 1:100

TYPE	SILL	LINTEL	SIZE	TYPE	SILL	LINTEL	SIZE
B	-	2550	1800x2550	W1	275	2550	1800x275
B1	-	2550	1200x2550	W2	700	2550	1200x700
B2	-	2550	900x2550	W3	275	2550	900x275
B3	-	2550	900x2550	W4	300	2550	900x300
B4	-	2550	750x2550	W5	350	2550	750x350
B5	-	2550	1500x2550	W6	350	2550	1500x350
B6	-	2550	1500x2550	W7	350	2550	1500x350
B7	-	2550	1500x2550	W8	350	2550	1500x350
B8	-	2550	1500x2550	W9	350	2550	1500x350
B9	-	2550	1500x2550	W10	350	2550	1500x350
B10	-	2550	1500x2550	W11	350	2550	1500x350
B11	-	2550	1500x2550	W12	350	2550	1500x350
B12	-	2550	1500x2550	W13	350	2550	1500x350
B13	-	2550	1500x2550	W14	350	2550	1500x350
B14	-	2550	1500x2550	W15	350	2550	1500x350
B15	-	2550	1500x2550	W16	350	2550	1500x350
B16	-	2550	1500x2550	W17	350	2550	1500x350
B17	-	2550	1500x2550	W18	350	2550	1500x350
B18	-	2550	1500x2550	W19	350	2550	1500x350
B19	-	2550	1500x2550	W20	350	2550	1500x350
B20	-	2550	1500x2550	W21	350	2550	1500x350
B21	-	2550	1500x2550	W22	350	2550	1500x350
B22	-	2550	1500x2550	W23	350	2550	1500x350
B23	-	2550	1500x2550	W24	350	2550	1500x350
B24	-	2550	1500x2550	W25	350	2550	1500x350
B25	-	2550	1500x2550	W26	350	2550	1500x350
B26	-	2550	1500x2550	W27	350	2550	1500x350
B27	-	2550	1500x2550	W28	350	2550	1500x350
B28	-	2550	1500x2550	W29	350	2550	1500x350
B29	-	2550	1500x2550	W30	350	2550	1500x350
B30	-	2550	1500x2550	W31	350	2550	1500x350
B31	-	2550	1500x2550	W32	350	2550	1500x350
B32	-	2550	1500x2550	W33	350	2550	1500x350
B33	-	2550	1500x2550	W34	350	2550	1500x350
B34	-	2550	1500x2550	W35	350	2550	1500x350
B35	-	2550	1500x2550	W36	350	2550	1500x350
B36	-	2550	1500x2550	W37	350	2550	1500x350
B37	-	2550	1500x2550	W38	350	2550	1500x350
B38	-	2550	1500x2550	W39	350	2550	1500x350
B39	-	2550	1500x2550	W40	350	2550	1500x350
B40	-	2550	1500x2550	W41	350	2550	1500x350
B41	-	2550	1500x2550	W42	350	2550	1500x350
B42	-	2550	1500x2550	W43	350	2550	1500x350
B43	-	2550	1500x2550	W44	350	2550	1500x350
B44	-	2550	1500x2550	W45	350	2550	1500x350
B45	-	2550	1500x2550	W46	350	2550	1500x350
B46	-	2550	1500x2550	W47	350	2550	1500x350
B47	-	2550	1500x2550	W48	350	2550	1500x350
B48	-	2550	1500x2550	W49	350	2550	1500x350
B49	-	2550	1500x2550	W50	350	2550	1500x350
B50	-	2550	1500x2550	W51	350	2550	1500x350
B51	-	2550	1500x2550	W52	350	2550	1500x350
B52	-	2550	1500x2550	W53	350	2550	1500x350
B53	-	2550	1500x2550	W54	350	2550	1500x350
B54	-	2550	1500x2550	W55	350	2550	1500x350
B55	-	2550	1500x2550	W56	350	2550	1500x350
B56	-	2550	1500x2550	W57	350	2550	1500x350
B57	-	2550	1500x2550	W58	350	2550	1500x350
B58	-	2550	1500x2550	W59	350	2550	1500x350
B59	-	2550	1500x2550	W60	350	2550	1500x350
B60	-	2550	1500x2550	W61	350	2550	1500x350
B61	-	2550	1500x2550	W62	350	2550	1500x350
B62	-	2550	1500x2550	W63	350	2550	1500x350
B63	-	2550	1500x2550	W64	350	2550	1500x350
B64	-	2550	1500x2550	W65	350	2550	1500x350
B65	-	2550	1500x2550	W66	350	2550	1500x350
B66	-	2550	1500x2550	W67	350	2550	1500x350
B67	-	2550	1500x2550	W68	350	2550	1500x350
B68	-	2550	1500x2550	W69	350	2550	1500x350
B69	-	2550	1500x2550	W70	350	2550	1500x350
B70	-	2550	1500x2550	W71	350	2550	1500x350
B71	-	2550	1500x2550	W72	350	2550	1500x350
B72	-	2550	1500x2550	W73	350	2550	1500x350
B73	-	2550	1500x2550	W74	350	2550	1500x350
B74	-	2550	1500x2550	W75	350	2550	1500x350
B75	-	2550	1500x2550	W76	350	2550	1500x350
B76	-	2550	1500x2550	W77	350	2550	1500x350
B77	-	2550	1500x2550	W78	350	2550	1500x350
B78	-	2550	1500x2550	W79	350	2550	1500x350
B79	-	2550	1500x2550	W80	350	2550	1500x350
B80	-	2550	1500x2550	W81	350	2550	1500x350
B81	-	2550	1500x2550	W82	350	2550	1500x350
B82	-	2550	1500x2550	W83	350	2550	1500x350
B83	-	2550	1500x2550	W84	350	2550	1500x350
B84	-	2550	1500x2550	W85	350	2550	1500x350
B85	-	2550	1500x2550	W86	350	2550	1500x350
B86	-	2550	1500x2550	W87	350	2550	1500x350
B87	-	2550	1500x2550	W88	350	2550	1500x350
B88	-	2550	1500x2550	W89	350	2550	1500x350
B89	-	2550	1500x2550	W90	350	2550	1500x350
B90	-	2550	1500x2550	W91	350	2550	1500x350
B91	-	2550	1500x2550	W92	350	2550	1500x350
B92	-	2550	1500x2550	W93	350	2550	1500x350
B93	-	2550	1500x2550	W94	350	2550	1500x350
B94	-	2550	1500x2550	W95	350	2550	1500x350
B95	-	2550	1500x2550	W96	350	2550	1500x350
B96	-	2550	1500x2550	W97	350	2550	1500x350
B97	-	2550	1500x2550	W98	350	2550	1500x350
B98	-	2550	1500x2550	W99	350	2550	1500x350
B99	-	2550	1500x2550	W100	350	2550	1500x350

GENERAL NOTES
1. ALL DIMENSIONS ARE IN MM.
2. ALL EXTERNAL WALLS 200 THK. & INTERNAL WALLS 125 THK. UNLESS OTHERWISE MENTIONED.
3. ALL MASONRY WORKS ARE BOUNDED BY CEMENT MORTAR (1:6) & (1:4).
4. EXTERNAL PLASTER IS 25 THK. & INTERNAL PLASTER IS 12MM. THK. WITH 1:4 MORTAR.
5. ALL CONC. GRADE IS M20 (1:1.5:3).
6. ALL WINDOWS ARE 500 MM. WIDE.

DISCLAIMER
THE DIMENSIONS WHICH ARE SHOWN IN THE SANCTION PLAN (OR SALE DRAWING) APPROVED BY THE AUTHORITIES ARE BARE ARCHITECTURAL DIMENSIONS. PHYSICAL DIMENSION POST FINISHING WILL REDUCE DUE TO FINISHES SUCH AS PLASTER, POP, FLOORING ETC. RESULTING SOME REDUCTION IN CARPET AREA.

CERTIFICATE OF GEO-TECHNICAL ENGINEER
UNDERSIGNED HAS INSPECTED THE SITE AND CARRIED OUT SOIL INVESTIGATION THEREON. IT IS CERTIFIED THAT THE EXISTING SOIL OF THE SITE IS ABLE TO CARRY THE LOAD COMING FROM THE PROPOSED CONSTRUCTION AND THE FOUNDATION SYSTEM PROPOSED HEREIN IS SAFE & STABLE IN ALL RESPECT FROM GEO-TECHNICAL POINT OF VIEW.

NAME OF GEOTECH ENGINEER
JISHNU PAL
B.TECH (CIVIL), M.E.(GEO-TECH)
EMPANELLED NO. - G.T./1/32
ADDRESS:
JP GEO CONSULTANTS
66, ANJALI ROAD, P.S.-SANKARIL
HOWRAH-700109

DECLARATION BY OWNER
1. I SHALL ENGAGE ARCHITECT AND E.S.E. DURING CONSTRUCTION.
2. I SHALL FOLLOW THE INSTRUCTIONS OF ARCHITECT AND E.S.E. DURING CONSTRUCTION OF THE BUILDING.
3. K.M.C. AUTHORITY WILL NOT BE RESPONSIBLE FOR STRUCTURE STABILITY OF BUILDING AND ADJOINING STRUCTURE.
4. IF ANY SUBMITTED DOCUMENT IS FOUND TO BE FAKE THE K.M.C. AUTHORITY MAY REMOVE THE SANCTION PLAN.
5. THE CONSTRUCTION OF WATER RESERVOIR AND SEPTIC TANK EXECUTED UNDER THE GUIDANCE OF ARCHITECT & E.S.E.
6. DURING DEPARTMENTAL INSPECTION PLOT IS IDENTIFIED BY ME.
7. EXISTING STRUCTURE TO BE DEMOLISHED BEFORE NEW CONSTRUCTION AND FULLY OCCUPIED BY OWNER AND NOT TENANTED.

NAME OF OWNER
MR. ARHANT M AGARWAL
AUTHORIZED SIGNATORY
FOR CAMPAIGN PROPERTIES LLP & 6 OTHERS
ADDRESS:
11A/1C EAST TOPSIA ROAD, KOLKATA - 700046

CERTIFICATE OF ARCHITECT
THE L.B.A. HAS CERTIFIED ON THE PLAN ITSELF WITH FULL RESPONSIBILITY THAT THE BUILDING PLAN HAS BEEN DRAWN UP AS PER PROVISION OF K.M.C. B.L.G. RULES 2009. AS AMENDED FROM TIME TO TIME AND THAT THE SITE CONDITION INCLUDING THE WIDTH OF THE ABUTTING ROAD CONFORM WITH THE PLAN AND IT IS A BUILD ABLE SITE AND NOT A TANK OR A FILLED UP TANK.
EXISTING STRUCTURE TO BE DEMOLISHED BEFORE NEW CONSTRUCTION AND FULLY OCCUPIED BY OWNER AND NOT TENANTED.
THE PLOT IS LOCATED WITHIN 500 M. FROM C/A OF E.M. BYPASS.
THE PLOT IS LOCATED WITHIN 1000 M. FROM METRO CORRIDOR.

NAME OF ARCHITECT
RAJ KUMAR AGARWAL
COUNCIL REGISTRATION NO. CA/94/17940
ADDRESS:
RAJ AGRWAL & ASSOCIATES
88, ROYD STREET (2ND FLOOR), KOLKATA-16.

CERTIFICATE OF STRUCTURAL ENGINEER
THE STRUCTURAL DESIGN OF BOTH FOUNDATION AND SUPERSTRUCTURE OF THE BUILDING HAVE BEEN MADE BY ME. CONSIDERING ALL POSSIBLE LOADS INCLUDING THE SEISMIC LOAD AS PER IS:800 OF INDIA AND CERTIFY THAT IT IS SAFE AND STABLE IN ALL RESPECT. SOIL INVESTIGATION REPORT HAS BEEN DONE BY JISHNU PAL (EMPANELLED NO.- G.T./1/32) NORTH BANBARA PALPARA, P.O. - BANBARA HOWRAH. THE RECOMMENDATION OF SOIL REPORT HAS BEEN CONSIDERED DURING STRUCTURAL CALCULATION.

NAME OF STRUCTURAL ENGINEER
DEBDAS BISWAS
B-TECH(CIVIL)
ENROLLMENT NO. :- E.S.E./1/272 OF KMC
ADDRESS:
BALBANBARIPUR,SOUTH 24 PARAGANA KOL-700144

NAME OF STRUCTURAL REVIEWER
MAINAK MAJUMDAR
ENROLLMENT NO. :- E.S.R./1/152/4
ADDRESS:
93/2 GARFA MAIN ROAD, KOLKATA-75.
B. P. NO. - 2024120385 DATED-06-JAN-25
VALID UP TO-05-JAN-30

DIGITAL OF SIGN OF A/E DIGITAL OF SIGN OF E/E

TITLE
GROUND FLOOR PLAN, BASEMENT PLAN, 1ST FLOOR PLAN

PROJECT
PROPOSED B+G+XVIII STORIED RESIDENTIAL BUILDING OF HEIGHT 59.95 M AT PRE. NO. 506, BARAKHOLA, P.S. - SURVEY PARK, KOLKATA-700 099, WARD NO-109, BOROUGH NO - 12, R.S. AND L.R. DAG NO. :- 97,99,100,101, R.S KHATTIAN NO. :- 152,160,161 L.R KHATTIAN NO. :- 304, 305, 306, 307, 308, 309 & 310 J.L. NO. :- 021, MOUZINA - BARAKHOLA. UNDER SECTION 393A OF K.M.C. ACT 1980 READ WITH K.M.C. BUILDING RULES 2009 AND RULE 69A(1)(c) OF WITH K.M.C. BUILDING RULES 2009.

DATE	DRG.NO	DEALT	CHECKED	SHEET NO
16.02.24		POULAMI	NORMAL	2 OF 3

SCALE
1:100

ARCHITECT
RAJ AGRWAL & ASSOCIATES
88, ROYD STREET, CALCUTTA-16